

OKLAHOMA DEPARTMENT OF TRANSPORTATION					
FED. ROAD DIST. NO.	STATE	PROJ. NO.	FISCAL YEAR	SHEET NO.	TOTAL SHEETS
6	OKLA	28839(04) 32530(04)			
DESCRIPTION			REVISIONS	DATE	

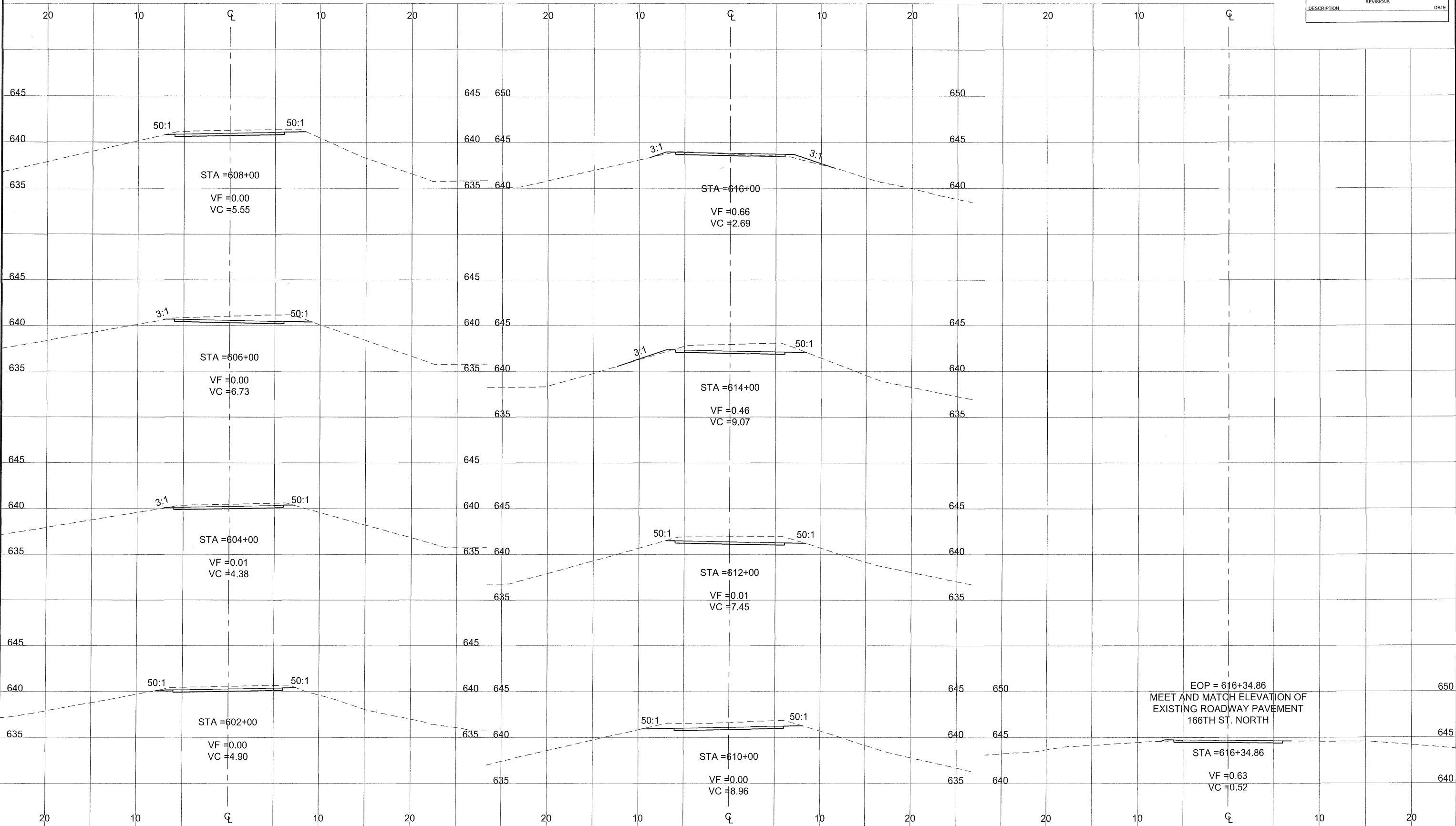

F:\681 Osage Prairie Trail Ext\Final\CAD BASE Files\Final\CAD Sections\0401R1.dwg, 6/15/2017 11:13:54 AM

NOTE:
 AGGREGATE BASE MATERIAL SHALL BE PLACED AS A CONTINGENCY ONLY FROM STA. 530+11 - END OF PROJECT. AGGREGATE BASE MATERIAL SHALL BE UTILIZED IN AREAS WHERE SPECIFIED COMPACTION CANNOT BE ATTAINED. USE OF AGGREGATE BASE ALONG THE RAIL BALLAST PORTION OF THE PROJECT MUST BE APPROVED BY THE ENGINEER BEFORE MATERIAL IS PLACED.

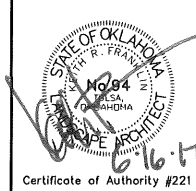
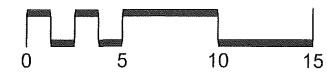

Osage Prairie Trail Extension		PREPARED BY: LANDPLAN CONSULTANTS 1110 West 23rd Street TULSA, OK 74107 918-584-6464	
Design	JM	8/16	CROSS SECTIONS (5) State Job No. 28839 (04), 32530 (04) Sheet No. 30 of 32
Drawn	JM/BB	8/16	
Checked	JM/KF	6/17	
Approved			
Squad	LPCI		